

copy machine

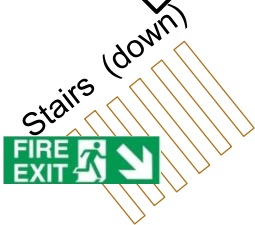
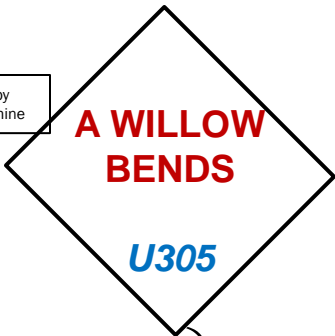

North

COC Admin Support
Jeane Holder

COC Admin Support
Michelle Allen



Elevator

U301
Lunch Sponsors

U302
Alicia Cover
WIOA

U303
WORKFORCE CENTER
Hank Nelson
Brent Kennedy

U304
Comm of Caring
Executive Director
Ted Borden

Stairs (down)

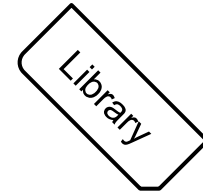
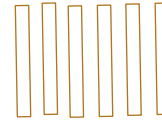

MAIN LEVEL

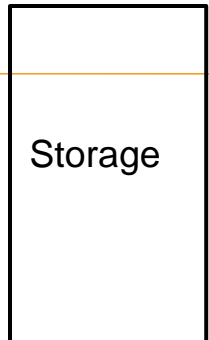
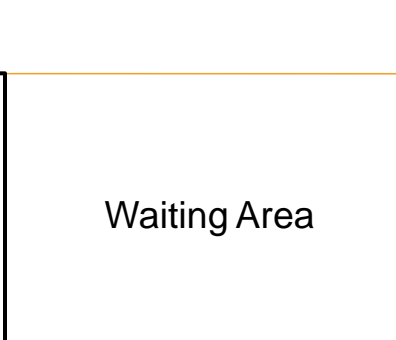
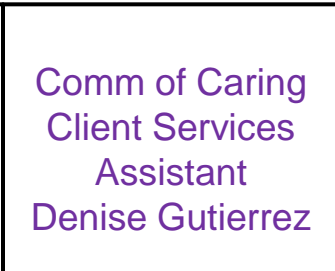
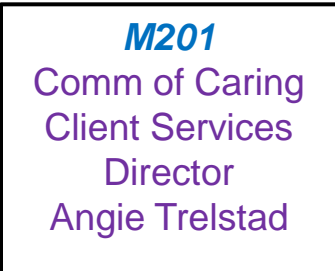
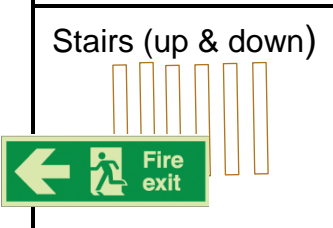
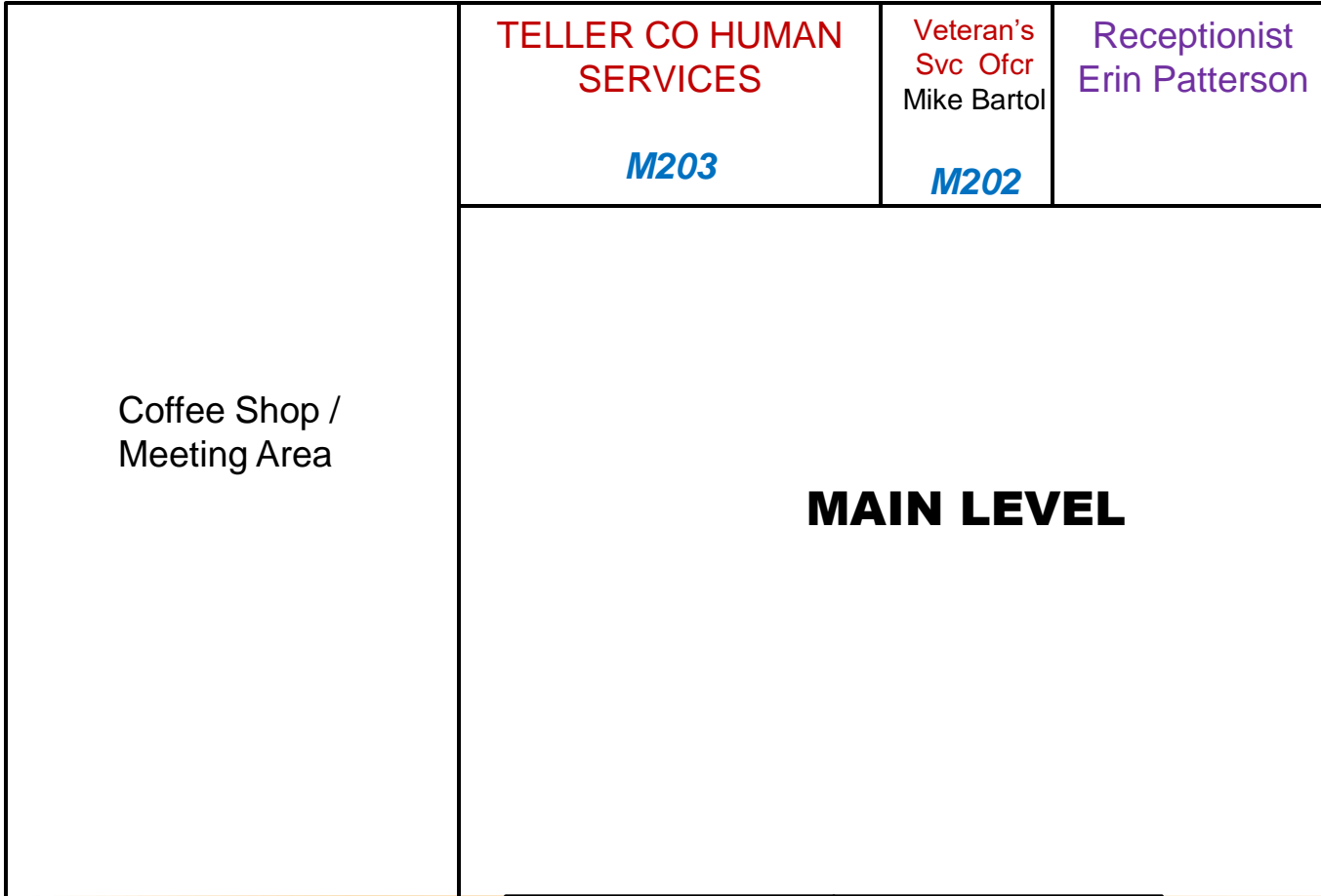

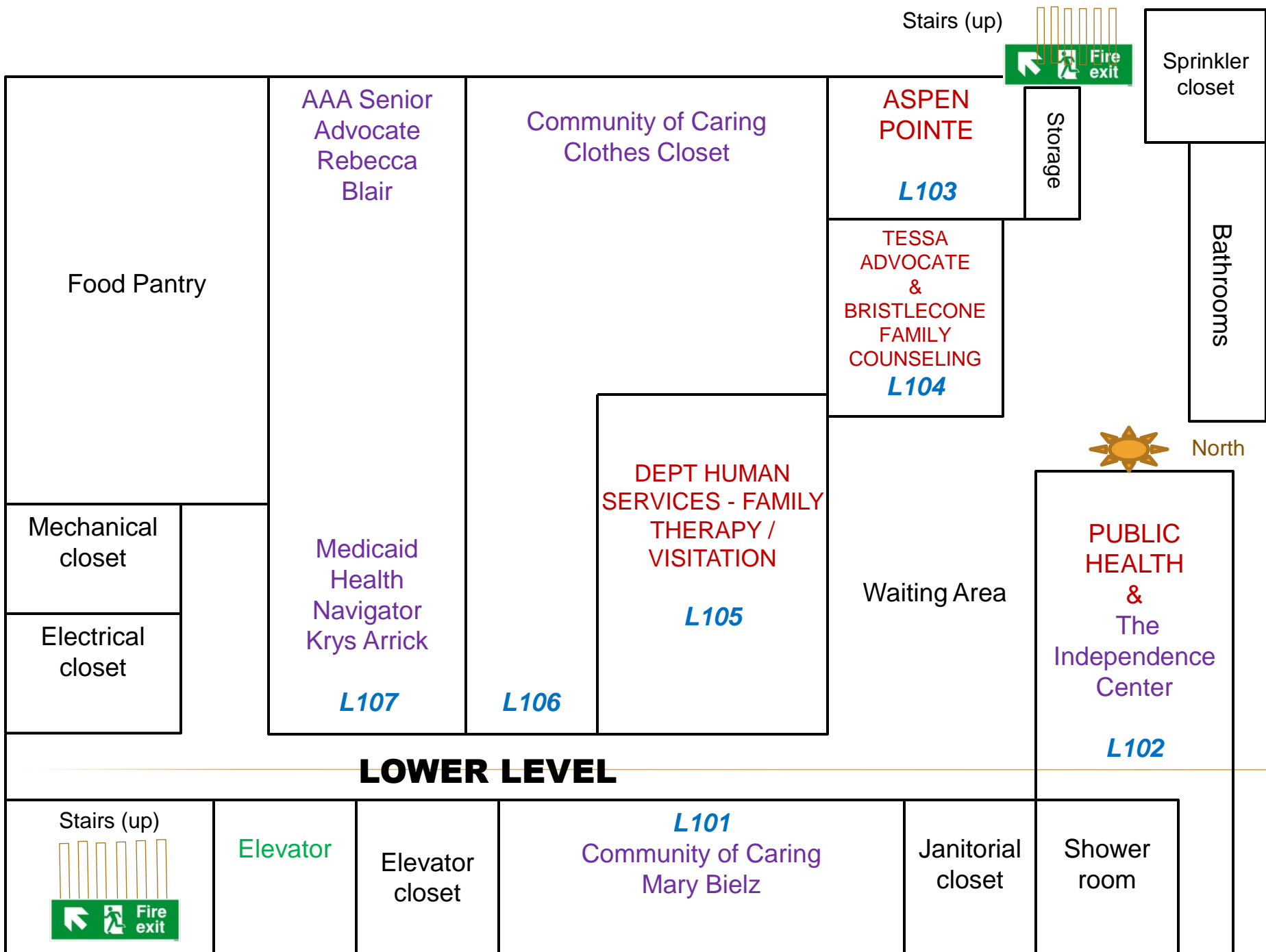

Stairs (up)



Sprinkler closet

AAA Senior Advocate
Rebecca Blair

Community of Caring
Clothes Closet

ASPEN
POINTE

L103

Storage

TESSA
ADVOCATE
&
BRISTLECONE
FAMILY
COUNSELING

L104

Bathrooms

Food Pantry

DEPT HUMAN
SERVICES - FAMILY
THERAPY /
VISITATION

L105



North

PUBLIC
HEALTH
&
The
Independence
Center

L102

Waiting Area

Mechanical
closet

Electrical
closet

Medicaid
Health
Navigator
Krys Arrick

L107

L106

LOWER LEVEL

Stairs (up)



Elevator

Elevator
closet

L101
Community of Caring
Mary Bielz

Janitorial
closet

Shower
room

ASPEN MINE CENTER BUILDING DIRECTORY

Lower Level

	Food Pantry	
L101	Mary Bielz - Community of Caring	Mon, Wed, Thurs, Fri
L101	Independence Center	Tuesday - 8am to 5pm
L102A	Public Health - WIC	Every other Wednesday - see schedule on door
L102B	Public Health - Admin	
L102C	Public Health Exam Room	
L103	Aspen Pointe	By appointment only - contact # 855-277-3678
L104	Advocate	Mon, Tues, Wed, Thurs - 9am to 5pm
L104	Bristlecone Family Counseling	Friday - 9am to 5pm
L105	Therapist	Mon, Wed - 9am to 5pm
L105	Dept Human Svcs Family Therapy / Visitation	By appointment only
L106	Clothes Closet	Mon thru Thurs - 8am to 5pm
L107	Rebecca Blair - AAA Senior Advocate	Tues thru Fri - 9am to 5pm
L107	Krys Arrick - Medicaid Health Navigator	Mon thru Thurs - 9am to 5pm
	Bathrooms	

Main Level

M201	Angie Trelstad - Director Client Services	Tues thru Fri - 9am to 5pm
	Denise Gutierrez - Client Services Assistant	Mon, Tues, Thurs, Fri - 9am to 5pm
	Library	Mon thru Fri - 9am to 5pm
	Erin Patterson - Receptionist	Mon thru Fri - 9am to 5pm
M202	Veteran's Affairs	Tuesdays - 9am to 1pm
M203	Teller County Dept Human Services	Mon thru Fri - 8am to 4:30pm

Upper Level

U301	Lunch Sponsors	
U302	Alicia Cover - WIOA	Tues & Wed - 8am to 5pm
U303	Pikes Peak Workforce Center	Mon thru Thurs - 9am to 4pm
U304	Ted Borden - COC Executive Director	Mon thru Thurs - 9am to 5pm
	Jeane Holder - Admin Support	
	Michelle Allen - Admin Support	
U305	A Willow Bends	Tues & Fri - 9am to 5pm
U306	Veldean Myers - COC Executive Assistant	Mon thru Thurs - 9am to 5pm
U307	Conference Room	
	Dining Room	
	Bathrooms	